

Pure performance by Granuldisk®

# Lean Wash Center®





# Lean Wash Center<sup>®</sup>

An innovative range designed to be easy to use and deliver efficient wash result, while consuming a minimum of natural resources.

Great for you, and better choice for our planet.



## Easy

- + Buy
- + Place
- + Install
- + Use
- + Clean
- + Maintain



## Sustainable

- + From 2.0 L per cycle
- + From 0.17 kWh per cycle
- + Silent - from 64 dB(A)
- + Energy saving mode
- + Long lifespan construction
- + Zero brass components



## Efficient

- + Minimum scrubbing
- + DIN 10534 compliance
- + Start-up from 9 min
- + Programs from 50 sec
- + AutoClean 3 min 30 sec
- + App for HACCP reporting

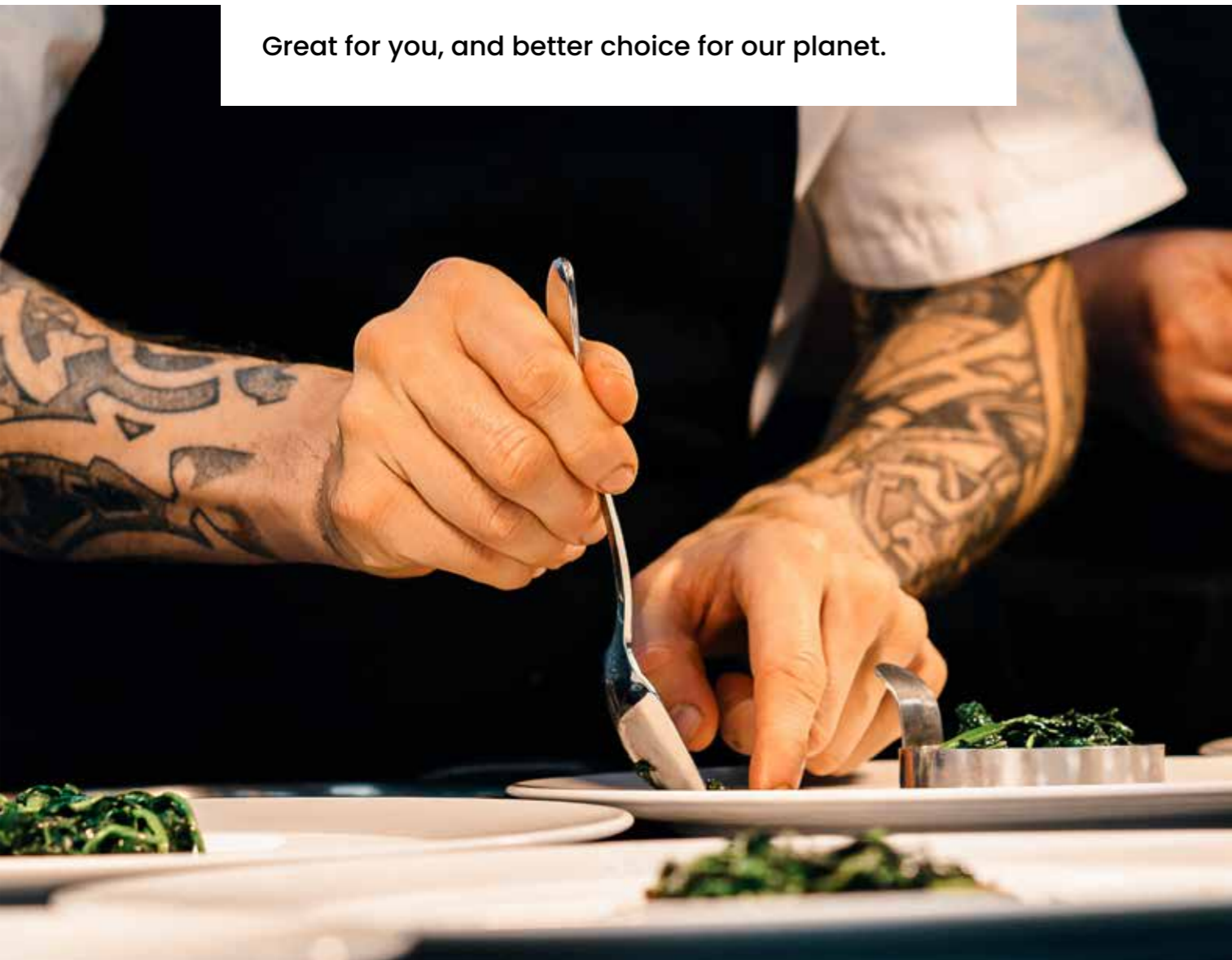

# Prep, cook, serve – wash!

X2 Lean Wash Center® washes all your dirty dishes from prep, cook and serve in one slim solution, making your operation more fluent, efficient, and profitable.



## Superior efficiency

X2 Lean Wash Center® is a versatile solution that washes your dirty pots, pans, saucepans and utensils, just as easily as your plates, cups, mugs, cutlery, and glasses.

- + Quick start-up and refill - minimum waiting time.
- + Dual wash technology - high and low pressure pumps and unique cookware baskets.
- + Minimum pre-scrapping and scrubbing required. Fast wash cycles ranging from 50 to 163 seconds.



## Less cost, more profit

Waste less, cut costs and become more profitable!

- + Minimum pre-washing - no more taps flowing all day long. Saves water, energy, chemicals and labor.
- + Low consumption - only 2 L of water, 0.171 kWh per wash program. Automatic energy saving mode.
- + Optimized maintenance costs - instant access to technical documentation, troubleshooting guides, and maintenance history.
- + The Sequential Rinse Technology decreases water and chemical consumption by 50%, which in turn helps save energy.



## Plug and play

X2 Lean Wash Center® operates with standard 500 x 500 mm baskets. Smooth installation - ready to use in minutes.

- + Minimum options - all is included.
- + Compatible with most tabling - install along wall or in a corner.
- + Adjustable operating panel in eye level and adjustable working height.



## As easy as child's play

Simply load your wash basket and slide it in. X2 Lean Wash Center® does the rest!

- + Low entry level - 4 icons for selecting the right wash program, auto clean feature, and QR code access to online training videos.
- + Specially designed baskets for optimized washing of a multitude of cookware.
- + Hands-free hood operation (automatic hood lift version).



## Future-proof

X2 Lean Wash Center® is Industry 4.0 ready. Connect and monitor one or multiple units through the app and secure HACCP traceability and compliance from day one.

- + Realtime collection of HACCP and performance data for HACCP compliance and optimization of consumption and maintenance.
- + Lean Wash Center® app for remote access - download free on Google Play or AppStore.



# Maximum efficiency

# versatility

**User-friendly interface**  
X2 Lean Wash Center® is intuitive to use and communicates via icons and info graphics, which eliminates language barriers.

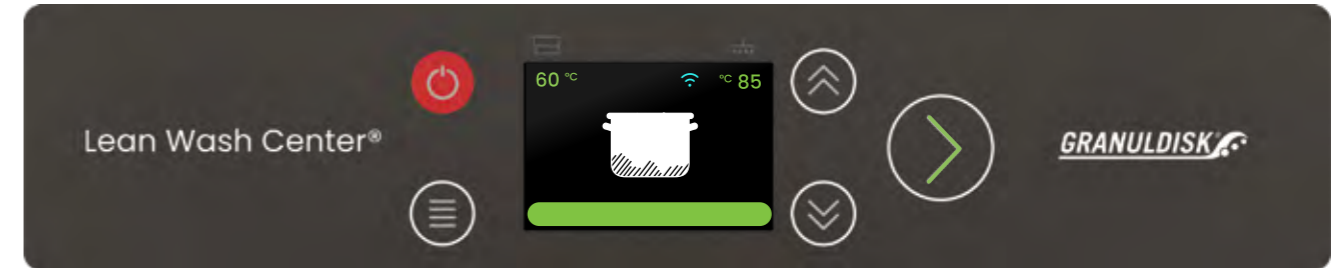

**Manual or automatic hood**  
Choose between manual or automatic hood lift version.



**All included**

- + Rear cover plate.
- + Double skinned heat and noise insulated hood.
- + Drain and discharge pump with water drain up to 800 mm.



**High end wash results**

Efficient dual - pump system with automatic activation of the right wash mode.

Load pots, pans, and a variety of cookware in the specially designed basket to activate the high-pressure pump and keep pre-washing at a minimum.

Load plates, mugs, forks, knives, and utensils in standard 500 x 500 mm dishwasher baskets to activate the dishwasher mode.



**4 tables, infinite possibilities**

Create your optimal setup by combining X2 Lean Wash Center® with smart reversible tables from Granuldisk. Adapt and rearrange your setup at any time.

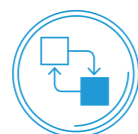

**Placing**

X2 Lean Wash Center® can be placed along a wall, or in a corner. Opt for the innovative Granuldisk® modular tabling for a lean and supportive ware washing center.



**Detergent and rinse aid dosing unit**  
Built-in liquid detergent and rinse aid dispenser with peristaltic pump.



**On site customizations**

Adjust temperature for wash and rinse programs, personalize working height, and place the operating panel on right or left side - all fully customizable, and done on site during installation.

**EcoExchanger®**

Optional efficient heat recovery system with steam reduction and condensing unit.



**SIMpel™**

QR code with online access to operator training videos, servicing history, and troubleshooting guides.



**Ergonomics**

Operating panel at eye level and within easy reach. Install on left or right side, depending on your preference.



2 L  
water/cycle  
(DIN 10534)

**Low consumption, high performance**

Install anywhere, without limitations. Start-up 9 minutes, water- change 5 minutes. Low water consumption 2 L per program.



**Hands-free operation**

Foot mechanism for a hands-free and no-touch system is standard for the automatic hood lift version.



**Connected HACCP compliance**

The built-in wifi feature allows you to connect any device to collect, edit, and monitor information such as HACCP data, consumption of chemicals and much more.

The Lean Wash Center App can be installed on smartphone, tablet, or laptop. Available on App Store and Google Play.



# Reversible tabling

Smart Swedish design makes each table configuration possible. Combine your X2 Lean Wash Center® with easy-to-install tables for a smart, safe, and well-thought out workspace.

## Fully reversible

Install right, left, or front! These smart tables with are fully reversible, and can easily be rearranged in a new configuration at any point in time. The space underneath offers storing of wash baskets, installation of an undercounter glass washer or water softener. That's smart Swedish design!

## Infinite possibilities

The concept consists of various tables that can be combined and extended in infinity to create your perfect washing station.

## The perfect match

The working height aligns perfectly with X2 Lean Wash Center, and the sliding zone secures easy operation of the cookware and dishware wash baskets.

## Adaptable capacity for banqueting

Monday 100 meals, Saturday 400.

By connecting two X2 Lean Wash Center® with the bridge table you can profit from a high productivity pass-through solution, matching that of a tunnel dishwasher.

During low periods or slow days, use only one X2 Lean Wash Center and save water, energy, and money.

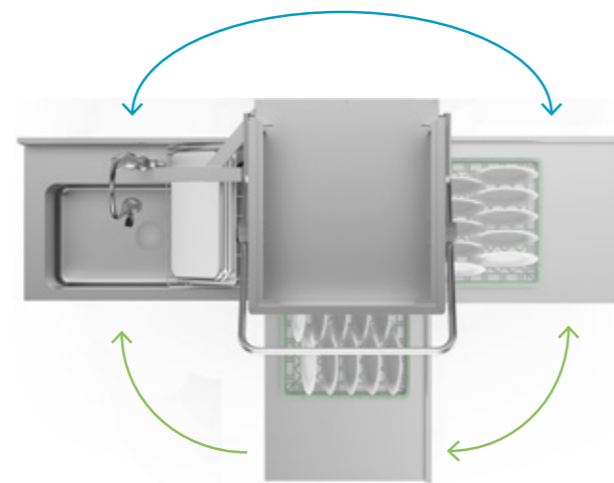

## Unique wash baskets for any items in prep, cook, serve

### Reversible wash basket - optional



Dishware wash mode capacity:  
9 x GN 1/1 • 18 x GN 1/2 serving trays  
max. depth 20 mm.  
Cookware wash mode capacity:  
18 x GN 1/1 grids • 9 x GN 1/1 lids or  
chopping board depth 20 mm  
• 2 x 600/400/20 mm pastry trays  
or chopping boards.

### Cookware wash basket 1 incl. in standard delivery



Cookware capacity: pots up to  
Ø 450 H 380 mm or sub-sized  
• 1 GN 1/1 depth 200 mm and sub-  
sized • 2 GN 1/1 or 4 GN 1/2 depth  
65 mm.

## Non-electric water softener for hot and cold water

Hard water causes scaling of the heating elements of electrical appliances, and leads to both over-consumption of electricity and increased maintenance costs.

Scaling will also impact your productivity significantly, as X2 Lean Wash Center® will run a high risk of loss of performance, and in worst case break down.

With this innovative and compact non-electric water softener, you no longer have to worry. Simply connect to water inlet temperature of 2-65 °C.

### Easy upkeep

8 kg salt. Check level weekly, refill when needed.



## Specification and technical details

Productivity	
Start-up time (fill and heat)	9 min. (water inlet 55 °C)
Water-change (drain, refill, reheat)	5 min. (water inlet 55 °C)
Consumption per wash program	Water: 2 L • Electricity: 0.171 kWh
Wash modes (automatic activation)	High pressure mode for cookware or low pressure mode for dishware and glassware.
Wash programs*	Cookware 120 sec. • Carbonized cookware 163 sec. • Short (Glassware) 50 sec. • Dishware and utensils 81 sec.
Cookware wash basket capacity	Pots up to Ø 450 H 380 mm or sub sized • 1 GN 1/1 depth 200 mm or sub-sized • 2 GN 1/1 or 4 GN 1/2 depth 65 mm
Reversible wash basket capacity	18 GN 1/1 grids • 9 GN 1/1 or 18 GN 1/2 lids or chopping board max. depth 20 mm • 2 pastry trays or chopping boards sized 600/400/20 mm • 9 GN 1/1 or 12 GN 1/2 serving trays max. depth 20 mm
Dishware wash basket capacity	18 dinner plates • 12 soup plates max. Ø 240 mm
Glassware wash basket capacity	25 glasses Ø 90 mm • 25 mugs Ø 90 mm
Standard delivery	
Manual hood lift version	Stainless steel ergonomic handle
Automatic hood lift version	Operate hood with hands-free foot mechanism or operating panel • Manual override possible
Operating panel	Right or left side - L 430 mm • At eye level and within easy reach • Smart control sensor panel with waterproof TFT color touch screen • Wash programs symbols
Loading	Standard basket 500 x 500 mm • Insert opening height 450 mm • Working height: 860-910 mm
Construction	Stainless steel • IPX5 • Stainless steel rear cover plate • Heat and noise insulated double skinned hood Drain and lift up pump up to 800 mm height
Wifi	Enables: HACCP data collection • Control of washing parameters • Remote access with detection of defective components • Lean Wash Center App is available on Google Play and AppStore.
SIMpel™	QR for online access to operator training videos, servicing history, and troubleshooting guides
Additional features	AutoClean program • Energy saving mode if not used for 20 min. • Shut-down timer
Chemicals dosing unit	Liquid detergent and rinse aid dosing dispenser with peristaltic pump • Suction hoses
Wash tank	30 L stamped tank • 8 kW heaters • 4 filters
Rinse tank	12 L stamped tank • 8 kW heaters
Cookware wash technology	2 stainless steel oscillating wash arms driven by motor • Removable without tool • Specially designed stainless steel nozzles • High pressure pump: 1.5 kW
Dishware & Glassware wash technology	2 stainless steel rotating wash arms driven by water pressure • Removable without tool • Specially designed nozzles • Low pressure pump: 1.1 kW
Rinse technology	2 stainless steel rinse arms • Removable without tool • Specially designed nozzles • Rinse pump: 0.18 kW
Wash water temperature*	Factory setting: 65 °C • Adjustable from 35 °C up to 65 °C
Rinse water temperature*	Factory setting: 85 °C • Adjustable from 65°C up to 85 °C
Starter kit	Stainless steel cookware wash basket • PP Dishware wash basket • PP Glassware wash basket w. large mesh
Installation kit	Supply hose 3/4" female • Drain hose Ø 28 mm • 2 m. electric cable.

### Factory fitted options

EcoExchanger***	Exhaust heat recovery with steam condensing unit • Self-cleaning function • 10°C/25°C water supply Extends wash cycle with 30 sec.
-----------------	---

### Installation and compliance

Dimension** and weight	Manual hood lift: H 1950 mm x W 655 mm x D 745 mm • Weight, gross/net: 178/138 kg Automatic hood lift: H 1950 mm x W 655 mm x D 785 mm • Weight, gross/net: 190/150 kg
Electrical - standard delivery	380V/400V/415V / 3N- / 50 -60 Hz • 25 A / 10 kW
Electrical - optional delivery	230V / 3N- / 50 -60 Hz • 32 A / 10 kW
Water inlet***	55 °C/60 °C • 2-5 bar • < 4 °dH -7 °f - 70 PPM • 3/4" female
Drain	Ø 28 mm • 65 °C • Ø 50 L/min.
Heat dissipation	Total: 5.8 kW - Sensible: 2.1 kW - Latent: 3.6 kW
Heat dissipation with EcoExchanger®	Total: 4.9 kW - Sensible: 2.1 kW - Latent: 2.8 kW
Sound pressure level (ISO 11203)	< 64 dB(A)
Norms and certification compliance	CE - DIN 10534 - EN 1717 - RoHS - WEEE

\* Factory settings - parameters fully customizable to each user.

\*\* Optional Eco Exchanger® extends dimensions to H 2125 mm X W 655 mm x D 785 mm.

\*\*\* If cold water supply, duration for start-up, water-change, and wash programs is extended.

# Let us help you build a strong business case!

How would X2 Lean Wash Center® be profitable to you?

Get a detailed business case in 2 minutes and discover your potential savings, calculated with your unique parameters.

The perfect base for a wise decision! Sign up for a free evaluation at [granuldisk.com](http://granuldisk.com)

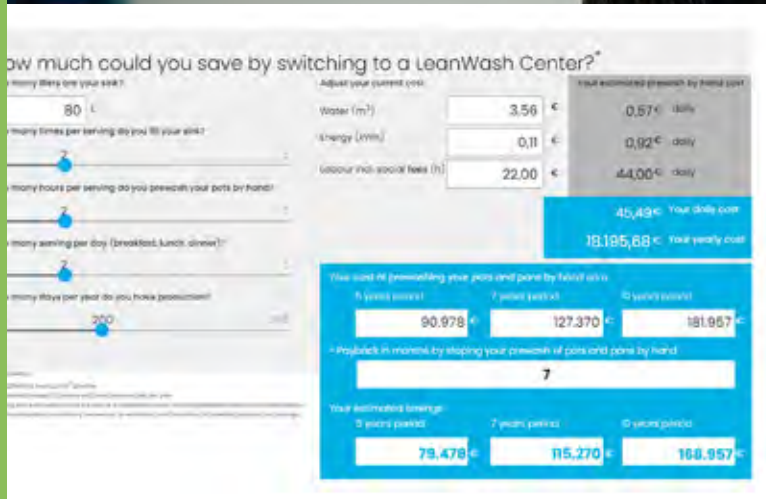

## Flexible financing

Own your product, or sign a Save per Use contract for a care-free and economic solution, in partnership with your local Granuldisk® partner.

Monthly fee includes installation, service, and maintenance.



## 24 months warranty included

X2 Lean Wash Center® comes with a contractual 24 months warranty.

*\* The warranty is valid only if annual maintenance has been performed by an authorized Granuldisk service partner.*

Authorized Premium Partner

### About Granuldisk

Granuldisk was founded in 1987 in Malmö, Sweden, and has since been revolutionizing commercial ware washing by combining premium engineering with high passion for sustainability, to ensure a perfect wash result in just a few minutes without any need to pre-wash by hand.

Granuldisk complies with environmental and quality ISO standards, and is actively working with the UN Sustainable Development Goals.

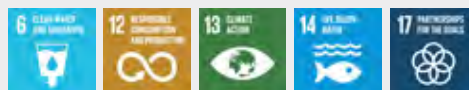

**GRANULDISK®**